



Feature

1. Flux build-up prevention is taken through inserting molding around the resistor with resin.
2. A large variety of products lined up to support various applications.
3. Dual Shaft and miniature design for audio applications.
4. Long Life Type Available.

8mm Rotary Potentiometer

Electrical characteristics

- Total Resistance 1K Ω ~ 1M Ω
- Resistance Tolerance 500 Ω < R < 1M Ω : $\pm 20\%$
R \leq 500 Ω or R \geq 1M Ω : $\pm 30\%$
- Resistance Taper A, B, C
- Max. Operating Voltage AC 50 V, DC 10V
- Rated Power 0.05W
- Rotational Noise 100 mV Max
- Insulation Resistance Less than 100M Ω at DC 250V
- Withstand Voltage 1 minute at AC 300V
- Residual Resistance 50 Ω Max
- Gang Error (Dual Unit Or Multiunit) -40db ~ 0db ± 3 db

Mechanical characteristics

- Detent 1 (Center) detent, 11 detents
- Total Rotational Angle 300 $^{\circ}$ $\pm 10^{\circ}$
- Push-Pull Strength Pull: 10Kgf Min.; Push: 10Kgf Min. at 10sec
- Rotational Torque 20 ~ 200gf.cm
- Stopper Strength 3.0Kgf.cm Min
- Shaft Wobble 0.5 mm Max
- Detent Torque 20 ~ 250gf.cm
- Bushing Nut Tighten Strength 10.0Kgf.cm

Durability

- Rotational Life Standard life: 30,000 Cycles Min.
Long life: 100,000 Cycles Min.
- Cold Test -20 $\pm 2^{\circ}$ C for 96 hours, $\Delta TR \leq \pm 15\%$
- Dry Heat 70 $\pm 2^{\circ}$ C for 96 hours, $\Delta TR \leq \pm 15\%$
- Temperature Cycle -20 ~ +70 $^{\circ}$ C, 5 cycles, $\Delta TR \leq \pm 15\%$
- Soldering Condition Solder dip: 260 $\pm 5^{\circ}$ C 5Sec
Manual Soldering: 350 $^{\circ}$ C $\pm 10^{\circ}$ C 3+1/-0 Sec
- Operating Temperature Range -10 $^{\circ}$ C ~ +70 $^{\circ}$ C

Switch characteristics

- Rated Power 3.0A at DC 16V
- Contact Resistance Less than 50m Ω
- Switch Angle 30 $^{\circ}$ $\pm 10^{\circ}$
- Switch Torque 50 ~ 250gf.cm
- Switch Life 25,000 cycles at without load

HOW TO ORDER

F082-	2	6	5	S	2	F	1	C	B	100K	
-------	---	---	---	---	---	---	---	---	---	------	--

Model Series	
Code	Gang Number
2	2 Gangs
4	4 Gangs

Code	Bushing Thread
6	M6
7	M7

Code	Length Of Bushing
5	5.0mm

Code	Switch Type
N	No Switch
S	With Rotary Switch

Code	Detent Option (Both Inner & Outer Shaft)
0	No Shaft Detent
1	With Center Detent
2	With 11 Shaft Detents

Shaft Type & Length	
See Note 1	

Full CCW Position	
See Note 2	

Code	Resistance Taper
A	Audio (15A)
B	Linear (Dual Gangs: 1B; Four Gangs And Up: 3B)
C	Reverse Audio(15C)
D	Audio (10A)

Total Resistance	
1K	
2K	
5K	
10K	
20K	
50K	
100K	
200K	
500K	
1MEG	

Code	Operation Life
(Blank)	Std. Life w/o anti-sulfur
1	Std. Life w/ anti-sulfur
2	Long Life w/ anti-sulfur
3	Long Life w/o anti-sulfur

Note 1: Shaft Type and Lengths

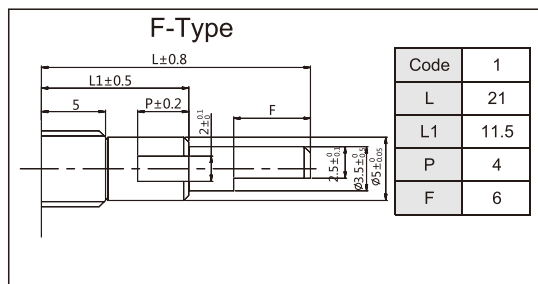

Note 2: Full C.C.W Shaft Position:

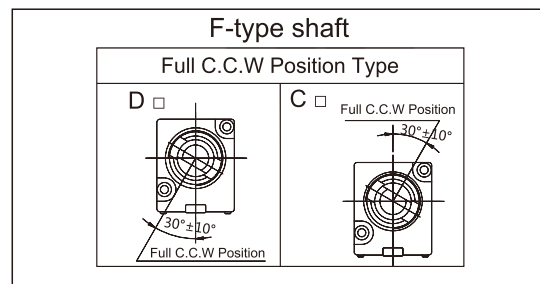

F082-265N Dual Shaft, 2 Gangs, M6 Bushing Thread, 5mm Bushing Length, No Switch

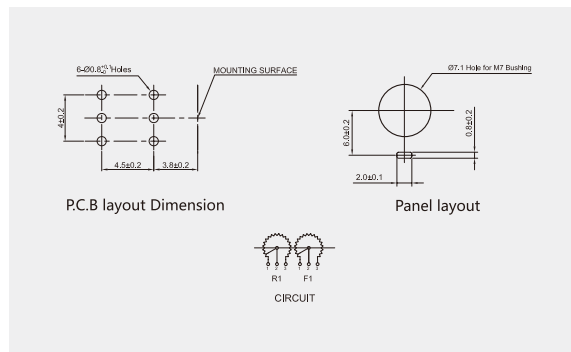
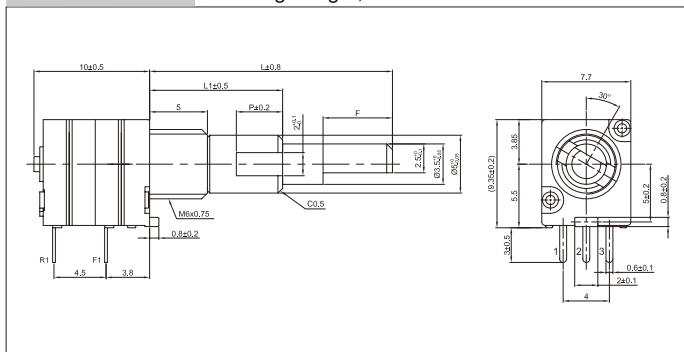

F082-275N Dual Shaft, 2 Gangs, M7 Bushing Thread, 5mm Bushing Length, No Switch

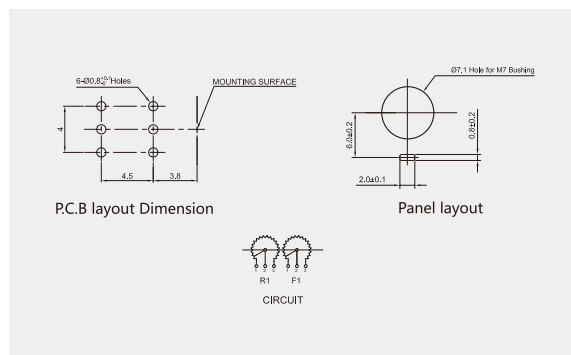
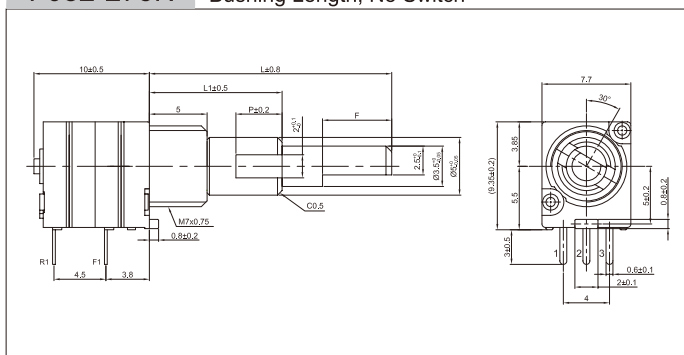

F082-465S Dual shaft, 4 Gangs, M6 Bushing Thread, 5mm Bushing Length, Rotary Switch

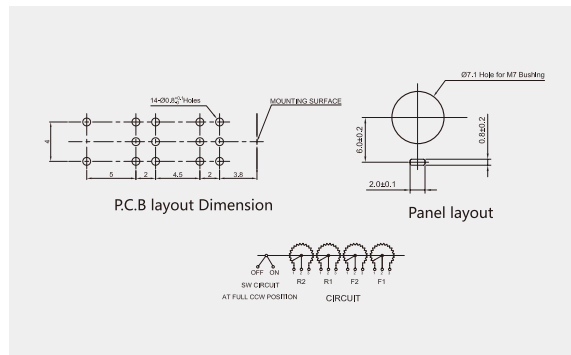
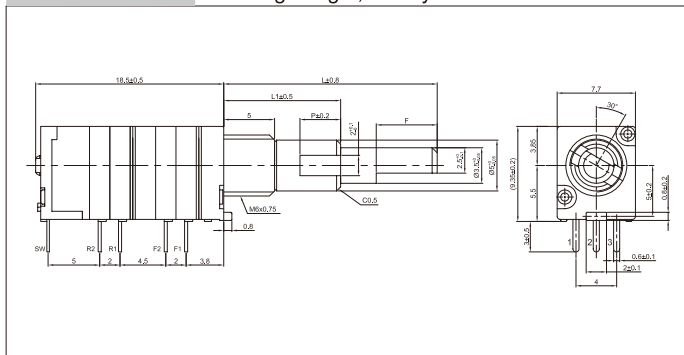

F082-475S Dual shaft, 4 Gangs, M7 Bushing Thread, 5mm Bushing Length, Rotary Switch

