

# F16 Series Rotary Potentiometer



Rotary Potentiometer

Joystick

Slide Potentiometer

Trimmer Potentiometer

Encoder

Switch

Sensor



## Feature

1. Carbon element
2. Switch option Molded case
3. Wide assortment of resistance tapers

## Application:

- Radio Volume Control
- Medical Equipment
- Electronic Toys

## Recommended model:

- ◆ F16-NN1B10K F16-NP1B10K F16-SN1B10K F16-SP1B10K F16-SD1B10K F16-ND1B10K

## Electrical Characteristics

Total Resistance	100Ω~1MΩ
Total Resistance Tolerance	±20%
Resistance Taper	A,B,C,D
Sliding Noise	Less than 100mV
Residual Resistance	Term.1~2: Less than 10Ω Term.2~3: Less than 10Ω
Max. Operating Power	Linear Taper B: AC 200V Other Tapers: AC 150V
Rated Power	Linear Taper B: 0.1W Other Tapers: 0.05W

## Mechanical Characteristics

Total Rotational Angle	260° ± 10°
Rotational Torque	10gf.cm~100gf.cm
Rotational Stopper Strength	2.0kgf.cm min.
Push-Pull Strength	Push: 1.0Kgf min.

## Switch Characteristics

Circuit	S.P.S.T
Contact Resistance	Less than 50m
Withstand Voltage	1 Minute at AC 500V
Rated Power	1.0A at AC/DC 12V
Torque	10gf.cm~100gf.cm
Strength	30° ± 10°

## Durability

Rotational Life	10,000 Cycles
-----------------	---------------

## HOW TO ORDER

<b>F16-</b>	<b>N</b>	<b>N</b>	<b>1</b>	<b>B</b>	<b>10K</b>
<b>Model Series</b>	<b>Terminal Length</b>	<b>Terminal Configuration</b>	<b>Resistance Taper</b>	<b>Total Resistance</b>	
	N: No Switch S: With Rotary Switch	N: Side Adjust, Solder Lugs P: Top Adjust, PC Pins D: Rear Adjust, PC Pins H: Side Adjust, PC Pins with Frame	A: Audio (15A) B: Linear (1B) C: Reverse Audio(15C) D: Audio(10A)	1K	2K
				5K	10K
				20K	50K
				100K	200K
				500K	1MEG
			<b>Shaft Length</b>		
			See Note1		

## Note1: Shaft Length

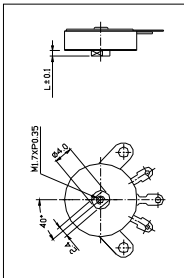

<b>Code</b>	<b>1</b>	<b>2</b>	<b>3</b>	<b>4</b>	<b>5</b>
<b>L</b>	1.2	1.5	2	3.2	5

## F16-NN1

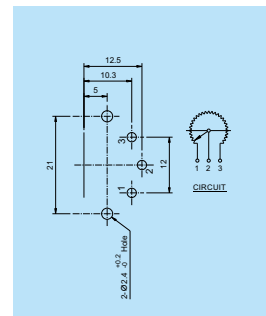
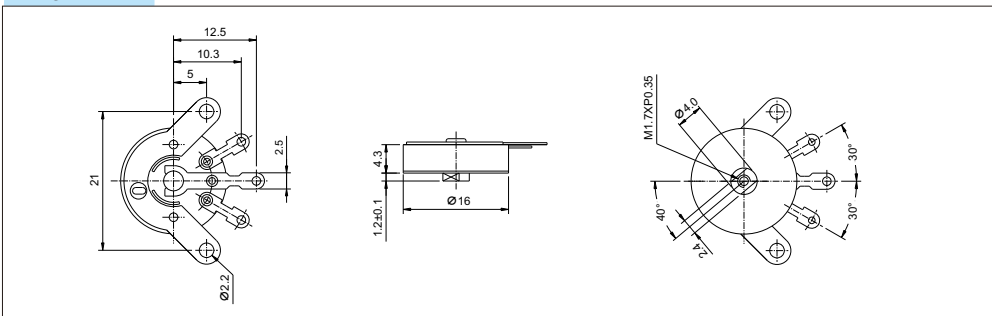

# F16 Series Rotary Potentiometer



Rotary Potentiometer

F16-SP1

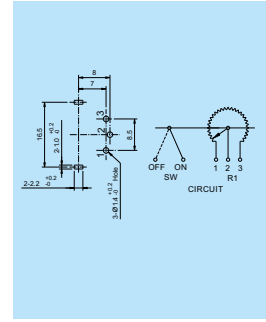
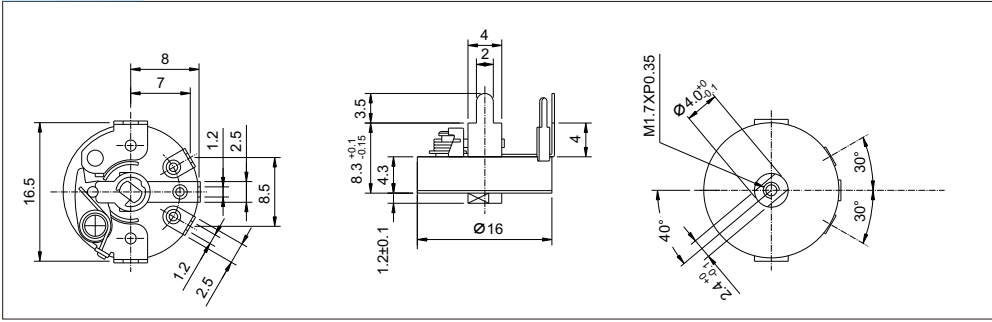

Joystick

F16-SN1

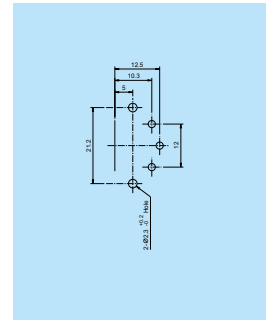
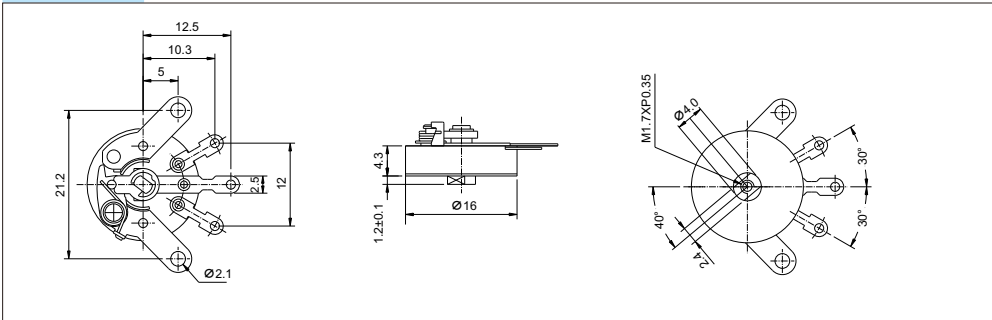

Slide Potentiometer

F16-SP1

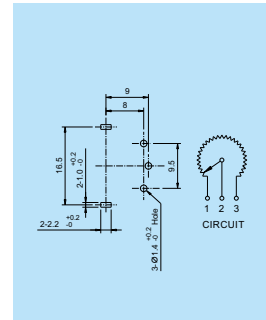
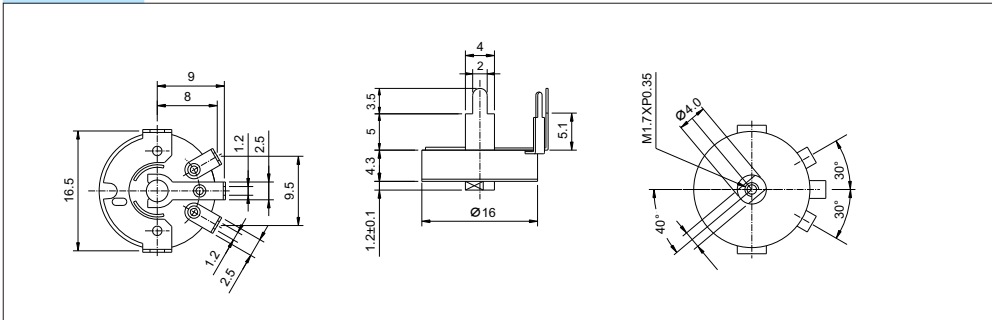

Trimmer Potentiometer

F16-ND1

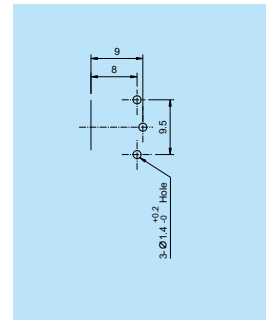
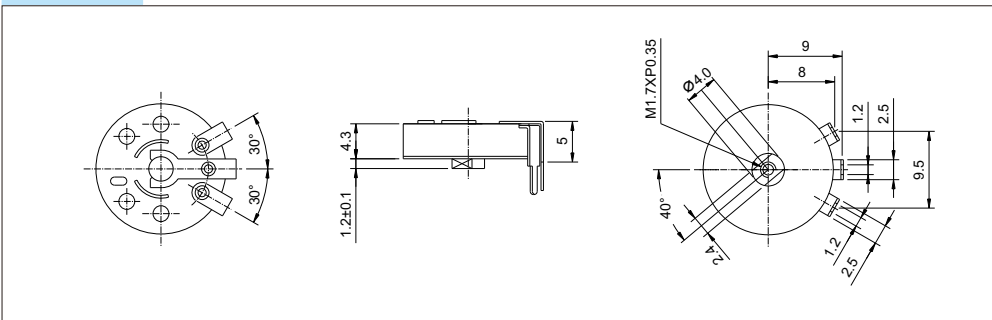

Encoder

F16-SD1

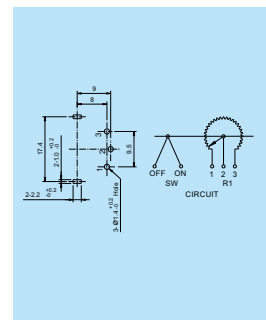
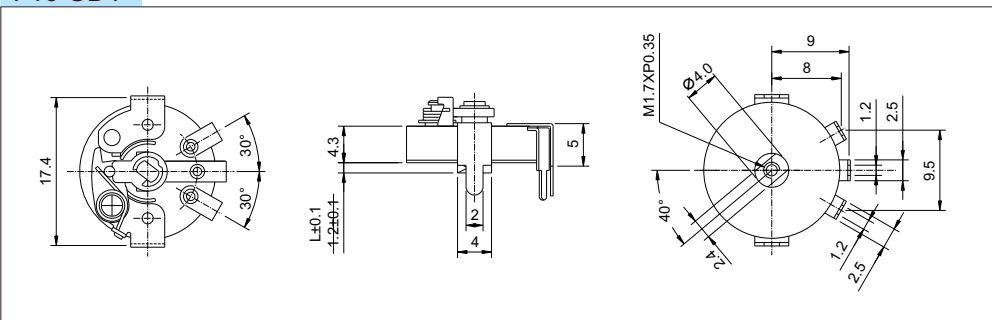

Switch

Sensor

